

Black Sanctum Walkthrough

Author: Shuttu

Last Update: 1st October 2009

Map

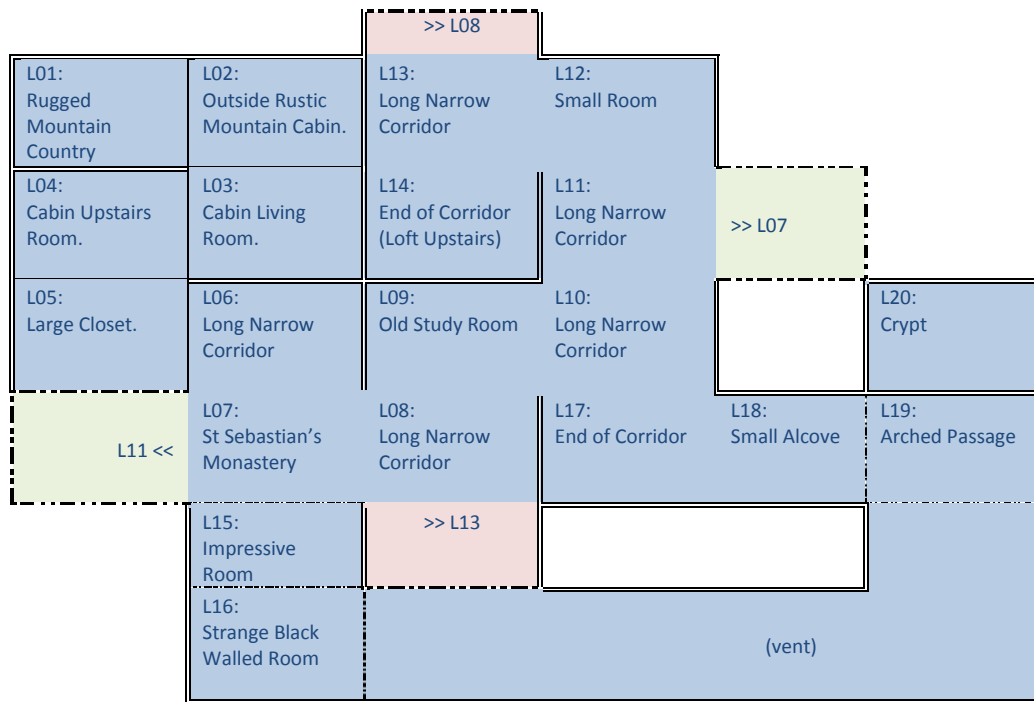

Step-by-Step guide

| Location | Action | Result | Inventory |
|----------|----------------|---|--|
| L01 | GO CABIN | L02 | |
| L02 | GET SHOVEL | | SHOVEL |
| | OPEN DOOR | | |
| | GO DOOR | L03 | |
| L03 | LOOK FIREPLACE | Found Mantle | |
| | LOOK MANTLE | Found Matches | |
| | GET MATCHES | | SHOVEL MATCHES |
| | GET JUG | | SHOVEL MATCHES JUG (WINE) |
| | GET NET | | SHOVEL MATCHES JUG (WINE) NET |
| | DROP SHOVEL | | MATCHES JUG (WINE) NET |
| | GO STAIRS | L04 | |
| L04 | LOOK BED | Found Sheet | |
| | GET SHEET | | MATCHES JUG (WINE) NET SHEET |
| | DROP SHEET | Get and drop to make sheet visible in room item list. | MATCHES JUG (WINE) NET |
| | LOOK WOMAN | She has long dark hair. A Note is clutched in her hand. | |
| | GET NOTE | | MATCHES JUG (WINE) NET NOTE |
| | READ NOTE | Reads... "Invocare Episcopus" | |
| | DROP NOTE | | MATCHES JUG (WINE) NET |
| | GO CLOSET | L05 | |
| L05 | GET ROBE | | MATCHES JUG (WINE) NET ROBE |
| | GO MIRROR | L06 | |
| L06 | GO SOUTH | L07 | |
| L07 | DROP MATCHES | | JUG (WINE) NET ROBE |
| | DROP NET | | JUG (WINE) ROBE |
| | GO EAST | L08 | |
| L08 | GO SOUTH | L13 | |
| L13 | GO SOUTH | L14 | |

continued...

| | | | |
|-----|--------------------|--|--|
| L14 | GO STAIRS | | |
| | DROP JUG | | ROBE |
| | GET KEYS | | ROBE KEYS |
| | GET SHEARS | | ROBE KEYS SHEARS |
| | GET SAW | | ROBE KEYS SHEARS SAW |
| | GO DOWN | | |
| | GO NORTH | L13 | |
| L13 | GO EAST | L12 | |
| L12 | GET JUG | | ROBE KEYS SHEARS SAW JUG (EMPTY) |
| | GO WEST | L13 | |
| L13 | GO NORTH | L08 | |
| L08 | GO WEST | L07 | |
| L07 | DROP SHEARS | | ROBE KEYS SAW JUG (EMPTY) |
| | DROP SAW | | ROBE KEYS JUG (EMPTY) |
| | DROP JUG | | ROBE KEYS |
| | UNLOCK DOOR | | |
| | DROP KEYS | | ROBE |
| | GO WEST | L11 | |
| L11 | GO SOUTH | L10 | |
| L10 | GO SOUTH | L17 | |
| L17 | GO EAST | L18 | |
| L18 | GET LANTERN | | ROBE LANTERN |
| | GO WEST | L17 | |
| L17 | GO NORTH | L10 | |
| L10 | GO WEST | L09 | |
| L09 | LOOK BOOKCASE | Found Manuscript | |
| | LOOK BOOKCASE | Found Parchment | |
| | GET MANUSCRIPT | | ROBE LANTERN MANUSCRIPT |
| | READ MANUSCRIPT | June 8, 1971: The Bishop has succumbed to the plague and has been laid to rest in the crypt. The brothers have elected to close the monastery. | |
| | DROP MANUSCRIPT | | ROBE LANTERN |
| | GET PARCHMENT | | ROBE LANTERN PARCHMENT |
| | READ PARCHMENT | Bach Fugue musical score. | |
| | GO SOUTH | L8 | |
| L8 | GO WEST | L7 | |
| L7 | GET MATCHES | | ROBE LANTERN PARCHMENT MATCHES |
| | GO DOOR | L15 | |

continued...

| | | | |
|-----|--------------------|---|---|
| L15 | PLAY BACH | Found secret passage! | |
| | DROP PARCHMENT | | ROBE LANTERN MATCHES |
| | GO PASSAGE | L16 | |
| L16 | LOOK CIRCLE | Found salt | |
| | GET SALT | | ROBE LANTERN MATCHES SALT |
| | DROP SALT | Makes salt a visible item in the room. | ROBE LANTERN MATCHES |
| | LOOK LECTURN | Found opening | |
| | LOOK OPENING | Found vent | |
| | GO VENT | L19 | |
| | LIGHT LANTERN | | |
| | GO NORTH | L20 | |
| L20 | GET HAMMER | | ROBE LANTERN MATCHES HAMMER |
| | LOOK COFFIN | It's closed! | |
| | OPEN COFFIN | A voice calls your name | |
| | LOOK COFFIN | Found skeleton, voice calls your name... | |
| | LISTEN | I will help you exorcise the evil that lurks here. You will need an altar crafted by your own hand, a white cloth cover, pure water to consecrate it, pine needles, a black feather, a lock of maidens hair and salt. Returns with these things and i will be here... | |
| | GO SOUTH | L19 | |
| L19 | EXTINGUISH LANTERN | It's dark! | |
| | GO VENT | L16 | |
| L16 | DROP LANTERN | | ROBE MATCHES HAMMER |
| | DROP MATCHES | | ROBE HAMMER |
| | GO PASSAGE | L15 | |
| L15 | GO NORTH | L07 | |
| L07 | GET SHEARS | | ROBE HAMMER SHEARS |
| | GET JUG | | ROBE HAMMER SHEARS JUG (EMPTY) |
| | DROP HAMMER | | ROBE SHEARS JUG (EMPTY) |
| | GO NORTH | L06 | |
| L06 | GO MIRROR | L05 | |
| L05 | GO WEST | L04 | |

continued...

| | | | |
|-----|---------------------------------|---------------------|---|
| L04 | LOOK WOMAN | | |
| | CUT HAIR | | |
| | GET HAIR | | ROBE SHEARS JUG (EMPTY) HAIR |
| | DROP SHEARS | | ROBE JUG (EMPTY) HAIR |
| | GET SHEET | | ROBE JUG (EMPTY) HAIR SHEET |
| | GO STAIRS | L03 | |
| L03 | GO DOOR | Snow blocking door! | |
| | GET SHOVEL | | ROBE JUG (EMPTY) HAIR SHEET SHOVEL |
| | DIG SNOW | | |
| | DROP SHOVEL | | ROBE JUG (EMPTY) HAIR SHEET |
| | GO DOOR | L02 | |
| L02 | GO WEST | L01 | |
| L01 | GET NEEDLES | | ROBE JUG (EMPTY) HAIR SHEET NEEDLES |
| | GET SNOW | | ROBE JUG (SNOW) HAIR SHEET NEEDLES |
| | GO CABIN | L02 | |
| L02 | GO DOOR | L03 | |
| L03 | GO STAIRS | L04 | |
| L04 | Woman has vanished from bed! | | |
| | GO CLOSET | L05 | |
| L05 | GO MIRROR | L06 | |
| L06 | GO SOUTH | L07 | |
| L07 | GO WEST | L11 | |
| L11 | GO SOUTH | L10 | |
| L10 | GO SOUTH | L17 | |
| L17 | GO EAST | L18 | |
| L18 | DROP NEEDLES | | ROBE JUG (WATER) HAIR SHEET |
| | DROP JUG | | ROBE HAIR SHEET |
| | DROP HAIR | | ROBE SHEET |
| | DROP SHEET | | ROBE |
| | GO WEST | L17 | |
| L17 | GO NORTH | L10 | |
| L10 | GO NORTH | L11 | |
| L11 | GO EAST | L07 | |
| L07 | GET NET | | ROBE NET |
| | GO DOOR | L15 | |
| L15 | GO PASSAGE | L16 | |

continued...

| | | | |
|-----|--------------|-----------------------------------|---|
| L16 | LOOK WOMAN | Woman has reappeared as a statue! | |
| | CATCH RAVEN | | ROBE NET RAVEN |
| | GET FEATHER | | ROBE NET RAVEN FEATHER |
| | DROP RAVEN | | ROBE NET FEATHER |
| | DROP NET | | ROBE FEATHER |
| | GET SALT | | ROBE FEATHER SALT |
| | GET LANTERN | | ROBE FEATHER SALT LANTERN |
| | GET MATCHES | | ROBE FEATHER SALT LANTERN MATCHES |
| | GO PASSAGE | L15 | |
| L15 | GO NORTH | L07 | |
| L07 | GO WEST | L11 | |
| L11 | GO SOUTH | L10 | |
| L10 | GO SOUTH | L17 | |
| L17 | GO EAST | L18 | |
| L18 | DROP MATCHES | | ROBE FEATHER SALT LANTERN |
| | DROP LANTERN | | ROBE FEATHER SALT |
| | DROP SALT | | ROBE FEATHER |
| | DROP FEATHER | | ROBE |
| | GO WEST | L17 | |
| L17 | GO NORTH | L10 | |
| L10 | GO NORTH | L11 | |
| L11 | GO EAST | L07 | |
| L07 | GET HAMMER | | ROBE HAMMER |
| | GET SAW | | ROBE HAMMER SAW |
| | GO WEST | L11 | |
| L11 | GO SOUTH | L10 | |
| L10 | GO SOUTH | L17 | |
| L17 | GO EAST | L18 | |

continued...

| | | | |
|-----|-----------------------|--|--|
| L18 | GO DOOR | Can't as boards are nailed to it! | |
| | PULL NAILS | Adds nails and boards to room item list! | |
| | GET NAILS | | ROBE HAMMER SAW NAILS |
| | GET BOARDS | | ROBE HAMMER SAW NAILS BOARDS |
| | MAKE ALTAR | Handcrafted altar added to room item list! | ROBE HAMMER SAW |
| | DROP SAW | | ROBE HAMMER |
| | DROP HAMMER | | ROBE |
| | GET LANTERN | | ROBE LANTERN |
| | GET MATCHES | | ROBE LANTERN MATCHES |
| | GET ALTAR | | ROBE LANTERN MATCHES ALTAR |
| | GET NEEDLES | | ROBE LANTERN MATCHES ALTAR NEEDLES |
| | LIGHT LANTERN | | |
| | DROP MATCHES | | ROBE LANTERN ALTAR NEEDLES |
| | GET FEATHER | | ROBE LANTERN ALTAR NEEDLES FEATHER |
| | GO DOOR | L19 | |
| L19 | GO NORTH | L20 | |
| L20 | DROP FEATHER | | ROBE LANTERN ALTAR NEEDLES |
| | DROP NEEDLES | | ROBE LANTERN ALTAR |
| | DROP ALTAR | | ROBE LANTERN |
| | GO SOUTH | L19 | |
| L19 | EXTINGUISH LANTERN | | |
| | GO DOOR | L18 | |

continued...

| | | | |
|-----|-------------------------------|---|--|
| L18 | GET SHEET | | ROBE LANTERN SHEET |
| | GET SALT | | ROBE LANTERN SHEET SALT |
| | GET MATCHES | | ROBE LANTERN SHEET SALT MATCHES |
| | GO DOOR | L19 | |
| L19 | LIGHT LANTERN | | |
| | GO NORTH | L20 | |
| L20 | DROP SALT | | ROBE LANTERN SHEET MATCHES |
| | DROP SHEET | | ROBE LANTERN MATCHES |
| | GO SOUTH | L19 | |
| L19 | EXTINGUISH LANTERN | | |
| | GO DOOR | L18 | |
| L18 | GET HAIR | | ROBE LANTERN MATCHES HAIR |
| | GET JUG | | ROBE LANTERN MATCHES HAIR JUG (WATER) |
| | GO DOOR | L19 | |
| L19 | LIGHT LANTERN | | |
| | GO NORTH | L20 | |
| L20 | A voice calls your name... | (if not, try another action like TAKE INVENTORY or LOOK until it does!) | |
| | LISTEN | Figure in white vestments... The spectre says... Well done! He sprinkles water on the altar, extends his hand and the objects on the altar burn to white ash. Go Now.... Throw this sanctified ash in their evil circle and promptly invoke my presence to protect you from the devil's wrath... | |
| | LOOK | Ashes appear in room item list! | |
| | GET ASHES | | ROBE LANTERN MATCHES JUG (WATER) ASHES |
| | GO SOUTH | L19 | |
| L19 | GO VENT | L16 | |
| L16 | DROP ASHES | | ROBE LANTERN MATCHES JUG (WATER) |
| | INVOCARE EPISCOPUS | Congratulations Game Over! | |

= THE END =